

# Installation Guide

## 安裝說明書

### Installation tips 安裝提示

※ Please read the HARDRACE Tech Tips before installing the products.  
在安裝之前請詳閱 HARDRACE 技術提示

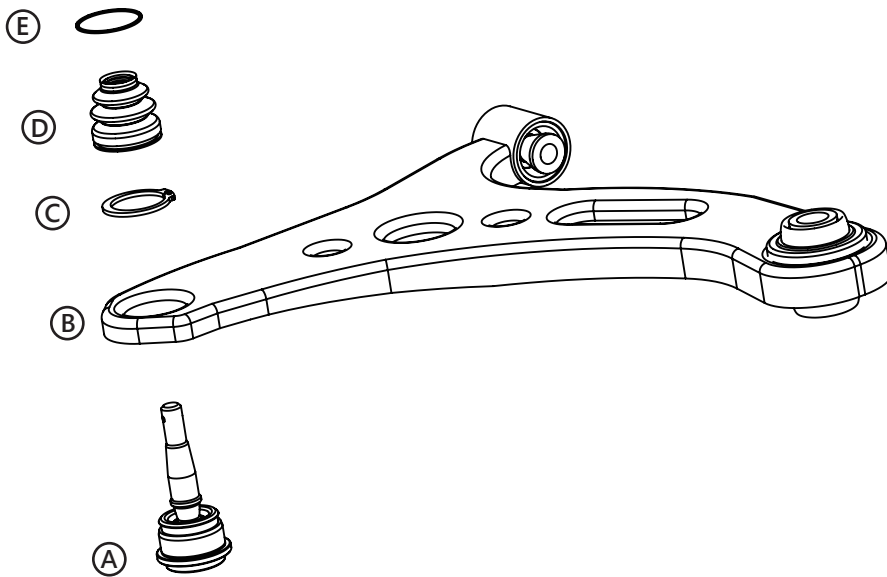

Steps of installation 安裝加長型和尚頭步驟：

Remove boot (D) and boot clamp (E) to avoid any damage while installing the ball joint.

先將防塵套(D)及束環(E)取下，避免和尚頭在安裝過程中破損或夾傷

Apply press machine or hydraulic tool to install the ball joint onto front lower arm, then install C ring (C), boot (D) and boot clamp (E).

使用壓床或液壓工具將和尚頭組合至三角架，再裝入C型環(C)及防塵套(D)以及防塵套束環(E)

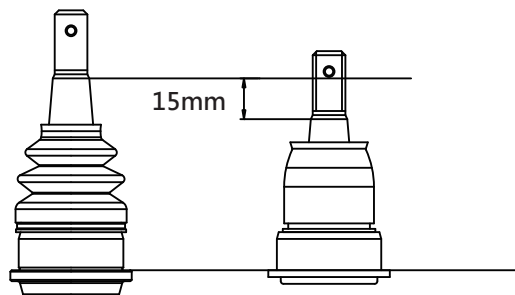

Length of ball stud is increased by 15mm to correct the horizontal position of front lower arm.

增加15mm長度  
補正三角架水平位置

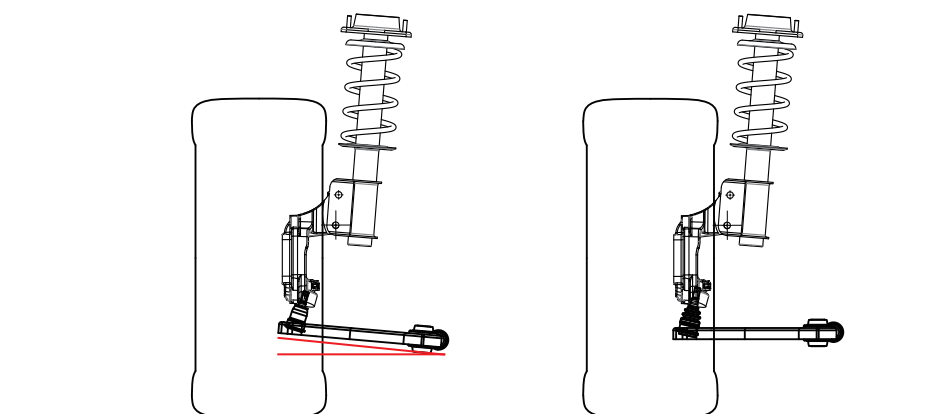

Before correction.  
未補正

Horizontal position after correction.  
補正三角架水平位置

### Warning 安全提示

Installation should only be performed by licensed mechanics who have the necessary skill and tools to do the job correctly and safely.

安裝需由合格之專業技師及工具執行，以確保安裝過程之正確與安全

When swapping the suspension kits, be sure to note the routing and mounting position of all wires, cables and bolts orientation, certain damage might be caused by reinstalling differently from the original factory position. Please refer to factory manual for proper installation and safety stands.

當更換您車輛之懸吊套件時，請記下您的線組與管線安裝位置，非原廠相同的安裝位置可能會造成元件之損壞，造成車輛的危險。請參考原廠車輛手冊