

### Application 適用車型

Honda Odyssey '13- (RC1/RC2)

### Components 內含配件

① Brace 結構桿.....1pcs

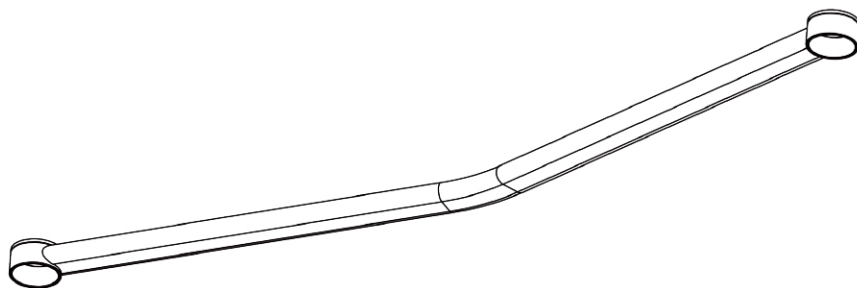

### Caution 注意事項

- Installation is recommended to be performed by licensed mechanics with necessary tools to ensure safety. Incorrect installation may cause injury, damage to the product or vehicle.  
安裝建議由合格的技師及工具執行以確保安全。安裝錯誤可能對人員、產品及車輛造成傷害。
- Note the routing of wires and cables before installation, or please refer to factory manual.  
安裝前請先記下線路的安裝路徑及位置以維持原廠配置。有疑問時請參考原廠手冊。
- Tighten bolts and nuts firmly by using handtools, and with specified torque if mentioned.  
安裝過程請使用手動工具確實鎖緊螺帽及螺絲。如有特別註明請依照說明指示的扭力上鎖。

### Instructions 安裝說明

1. Remove the subframe bolts on both sides.  
(See figure 1&2)  
拆卸前副車架兩側的螺絲。(參考圖表一、二)
2. Position the brace on the vehicle.  
安裝結構桿。
3. Reinstall the bolts to secure the brace.  
鎖回螺絲以將桿身固定。



See figure 1 (參考圖表一)



See figure 2 (參考圖表二)

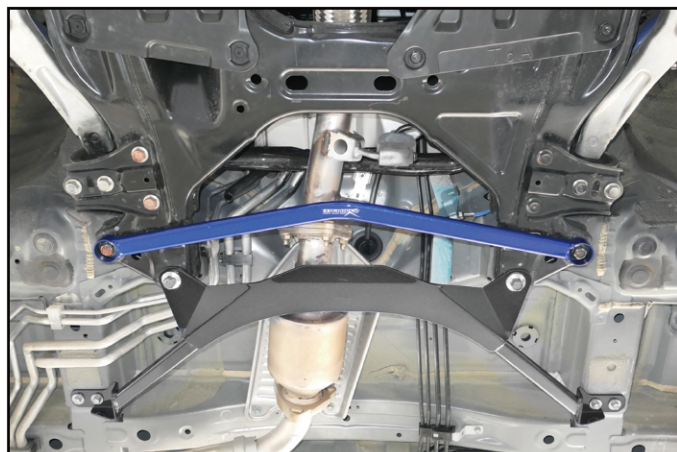

Illustration of installed state  
安裝完成示意圖