

HARDRACE

HONDA CIVIC

10th

TYPE-R

FK8

2017-2022



APPLICABLE PARTS OVERVIEW

PRODUCT CATEGORY	PRODUCT NAME	PART NO.	TYPE	PCS/SET	PRODUCT DESCRIPTION
ARM	FRONT LOWER STOPPER LINK	Q0677	Adjustable	2	Caster +1 ~ -0.5 degree
		Q0843		2	OE Replacement
	REAR CAMBER KIT	8646	Adjustable	2	Pillow Ball Equipped
		8647-S	Adjustable	2	Harden Rubber Equipped
	REAR TOE KIT	8648	Adjustable	2	Pillow Ball Equipped
		8649-S	Adjustable	2	Harden Rubber Equipped
BAR AND BRACE	REAR LOWER ARM	Q0957	Adjustable	2	Pillow Ball Equipped
	FRONT STRUT TOWER BRACE	Q0666		1	For Left Hand Drive Models
	FRONT SUBFRAME REINFORCEMENT BRACE	Q1002		1	-
	REAR SUBFRAME REINFORCEMENT BRACE	Q1000		1	-
	REAR SUBFRAME BRACE	Q1001		1	-
	FRONT TOW HOOK ADAPTER	Q0722		1	Thread size: M18x2.5
BUSHING	FRONT STRUT MOUNT / CAMBER PLATE	Q1490	Adjustable	2	Pillow Ball Bearing
	FRONT LOWER ARM BUSHING	Q0646		2	Harden Rubber Equipped
	REAR TRAILING ARM BUSHING	Q0929		2	Pillow Ball Equipped
		Q0234		2	Harden Rubber Equipped
	REAR LOWER ARM BUSHING	Q0930		2	Pillow Ball Equipped
		Q0931		2	Harden Rubber Equipped
	REAR KNUCKLE BUSHING - CONNECT TO LOWER ARM	Q0958		2	Pillow Ball Equipped
	SHIFTER CABLE BUSHING	Q1027		2	Solid Aluminum
ENGINE MOUNT	RIGHT SIDE ENGINE MOUNT	Q1064		1	-
	HARDEN ENGINE MOUNT - REAR SIDE	Q0676		1	Aluminum Body
	LEFT SIDE TRANSMISSION MOUNT	Q1060		1	-
EXTENDED WHEEL STUD	EXTENDED WHEEL STUD	Q0587		20	30mm Extended
ROLL CENTER TIE ROD END	RC TIE ROD END	Q0320	Adjustable	2	Pillow Ball Equipped
ROLL CENTER BALL JOINT	FRONT ROLL CENTER ADJUSTER	Q0954		2	Height +5mm
		Q0675		2	Height +10mm
	FRONT LOWER CAMBER ADJUSTER	Q0094	Adjustable	2	Camber Adjustable
STABILIZER LINK	ADJ. STABILIZER LINK	8659-340	Adjustable	2	Range: 320-359 mm / Ball stud: M10
	REAR ADJ. STABILIZER LINK	Q1277	Adjustable	2	Range: 60-70mm
	REAR STABILIZER LINK	8655		2	CNC Aluminum Body + Pillow Ball
SWAY BAR	FRONT SWAY BAR	Q1225		3	30 mm
	REAR SWAY BAR	8645		3	22 mm

ARM

The stopper links on Civic Type-R connect lower control arms and damper forks. By altering damper fork angles, Hardrace adjustable stopper links help you dial Caster settings for greater stright-line stability and steering response.



FRONT LOWER STOPPER LINK FRONT LOWER STOPPER LINK

Camber kit reduces tire wear and increase tire durable. Made with superior quality bushing, provide advanced stability and accurate response steering, especially during high speed driving and cornering.



REAR CAMBER KIT

REAR CAMBER KIT



REAR TOE KIT

REAR TOE KIT

The rear lower arm allows fine adjustment to the rear end camber setting of the vehicle. It can either help maximize wheel contact patch to improve cornering grip or get your car back to original alignment specs after lowering to prevent uneven tyre wear.

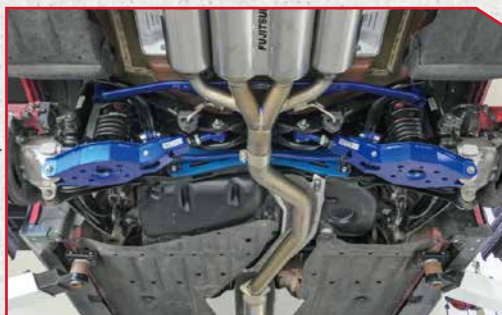

REAR LOWER ARM

- ◆ Offers camber adjustability to suit various driving conditions.
- ◆ High-strength boxed steel alloy construction.
- ◆ Premium quality pillow ball bushings equipped.
- ◆ Improve handling performance .
- ◆ OE direct replacement.

BAR AND BRACE

The brace features aluminum alloy center bar for extreme lightweight and superior strength. By tying the strut towers together, the brace capably eliminate lateral body deflections and maintain proper suspension geometry under high speed driving and hard cornering, offering a more precise and connected handling response.

**FRONT STRUT TOWER BRACE**

Hardrace is proud to announce the new front subframe reinforcement brace for Civic Type-R. The brace will reduce vehicle chassis flex and deflection to increase the rigidity of your car under high speed driving and hard cornering, resulting in better and quicker handling response.

**FRONT SUBFRAME
REINFORCEMENT BRACE****REAR SUBFRAME BRACE****REAR SUBFRAME
REINFORCEMENT BRACE**

Hardrace is proud to announce front tow hook adapter for Civic Type-R FK8. The factory front tow hook of Civic Type-R is located far back underneath the chassis. This not only result in inconvenience but also risks of damaging front splitter when attaching towing straps. The front tow hook adapter features high strength steel alloy construction and is compatible with any M18x2.5 thread aftermarket tow hooks. By fitting a new tow hook directly mounted to front bumper beam bolts, it provides a safer, more practical and sportier looking towing option to your vehicle, definitely a must have for track cars.

**FRONT TOW HOOK ADAPTER**

- ♦ High strength steel alloy construction.
- ♦ ED coated and painted for highest durability.
- ♦ Relocate tow hook for better practicality.
- ♦ Compatible with M18x2.5 thread aftermarket tow hooks.

BUSHING

- ♦ The harden rubber bushings are made of high strength and anti-crack rubber materials to offer solid handling response and resistance to unwanted suspension movement during hard acceleration, braking and cornering.
- ♦ Pillow ball bushing provides excellent driver feedback, precise control and solid suspension feel. The bushing is made of precisely made high molecule plastic tube and specific steel alloy for superior durability and reliability. The Outer side utilizes TPV material anti-dust boot, 100% resistant from dust, water and oil, extend the life of the bushing.

Q1490

Pillow Ball
Bearing

**FRONT STRUT MOUNT /
CAMBER PLATE**

Q0646

Harden Rubber
Equipped

**FRONT LOWER ARM
BUSHING**

Q0929

Pillow Ball
Equipped

**REAR TRAILING ARM
BUSHING**

Q0234

Harden Rubber
Equipped

**REAR TRAILING ARM
BUSHING**

Q0930

Pillow Ball
Equipped

**REAR LOWER ARM
BUSHING**

Q0931

Harden Rubber
Equipped

**REAR LOWER ARM
BUSHING**

Q0958

Pillow Ball
Equipped

**REAR KNUCKLE BUSHING
- CONNECT TO LOWER ARM**

Q1027
SHIFTER CABLE BUSHING

ENGINE MOUNT / EXTENDED WHEEL STUD

The reinforced engine mount is made by hardened rubber. With improved strength over the OE rubber mounts, it reduces engine movement significantly and provides maximum output under engine acceleration.

Q1064
RIGHT SIDE ENGINE MOUNT

Q0676
**HARDEN ENGINE MOUNT
- REAR SIDE**

Q1060
**LEFT SIDE TRANSMISSION
MOUNT**

Q0587

30mm Extended

EXTENDED WHEEL STUD

ROLL CENTER TIE ROD END / ROLL CENTER BALL JOINT

Q0320
RC TIE ROD END

Q0954

Height +5mm

**FRONT ROLL CENTER
ADJUSTER**

Q0675

Height +10mm

**FRONT ROLL CENTER
ADJUSTER**

Q0094

CAMBER
ADJUSTABLE

**FRONT LOWER CAMBER
ADJUSTER**

STABILIZER LINK

Hardrace Stabilizer Link precision assembly production enables spheroid, self-lubricating plastic bearing and bracket has a tight joint, providing a high quality and longer life.

- ◆ More direct energy transfer and feel.
- ◆ Constructed of high-strength aluminum alloys that offer durability.
- ◆ Manufactured to match OE fit.

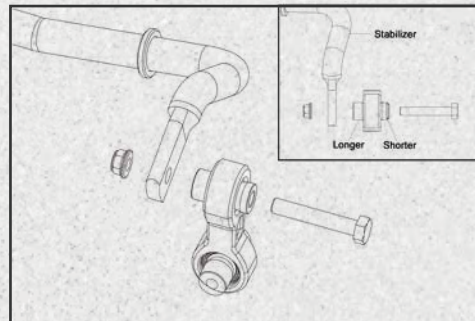

ADJ. STABILIZER LINK



REAR ADJ. STABILIZER LINK



REAR STABILIZER LINK

SWAY BAR

Sway Bar affects handling and the car's oversteer and understeer characteristic. It ties the suspension arms together across the front or rear end and keeps your car flat in turns instead of leaning over to one side, offering better stability and handling response especially at high speeds and cornerings.



FRONT SWAY BAR



REAR SWAY BAR



CHASSIS PARTS DIAGRAM

FRONT

Q0666 //
FRONT STRUT TOWER BRACE

Q1225 //
FRONT SWAY BAR

Q1002 //
FRONT SUBFRAME
REINFORCEMENT BRACE

Q0722 //
FRONT STRUT TOWER BRACE

Q0676 //
HARDEN ENGINE MOUNT
- REAR SIDE

Q0677 //
FRONT LOWER STOPPER LINK

REAR

Q1000 //
REAR SUBFRAME
REINFORCEMENT BRACE

8645 //
REAR SWAY BAR

8647-S //
REAR CAMBER KIT

Q1001 //
REAR SUBFRAME BRACE

8655 //
REAR STABILIZER LINK

8649-S //
REAR TOE KIT

Q0957 //
REAR LOWER ARM

