

HARDRACE

TESLA MODEL 3

2017
PRESENT



APPLICABLE PARTS OVERVIEW

PRODUCT CATEGORY	PRODUCT NAME	PART NO.	TYPE	PCS/SET	PRODUCT DESCRIPTION	
ARM	FRONT UPPER CAMBER KIT	Q0869	Adjustable	2	Pillow Ball Equipped	
		Q0603	Adjustable	2	Harden Rubber Equipped	
	FRONT LOWER FRONT ARM	Q1319		2	Pillow Ball Equipped	
		Q1229		2	Harden Rubber Equipped	
	FRONT LOWER REAR ARM	Q1320		2	Pillow Ball Equipped	
		Q1230		2	Harden Rubber Equipped	
	REAR CAMBER KIT	Q0996	Adjustable	2	Pillow Ball Equipped	
		Q0604	Adjustable	2	Harden Rubber Equipped	
	REAR TOE KIT	Q0997	Adjustable	2	Pillow Ball Equipped	
		Q0605	Adjustable	2	Harden Rubber Equipped	
	REAR UPPER FRONT ARM	Q0998	Adjustable	2	Pillow Ball Equipped	
		Q0612	Adjustable	2	Harden Rubber Equipped	
	REAR TRAILING ARM	Q0999	Adjustable	2	Pillow Ball Equipped	
		Q0613	Adjustable	2	Harden Rubber Equipped	
BAR AND BRACE	FRONT LOWER BRACE	Q0911		1	-	
	BRAKE MASTER CYLINDER STOPPER	Q0910		1	For Right-hand Drive Cars Use	
		Q0709		1	For Left-hand Drive Cars Use	
BUSHING	FRONT UPPER ARM BUSHING	Q1488		4	Harden Rubber Equipped	
	FRONT LOWER FRONT ARM BUSHING - INNER	Q0861		2	Pillow Ball Equipped	
		Q1077		2	Harden Rubber Equipped	
	FRONT LOWER FRONT ARM BUSHING - SHOCK	Q1047		2	Harden Rubber Equipped	
	FRONT LOWER REAR ARM BUSHING	Q0881		2	Pillow Ball Equipped	
		Q0885	Adjustable	2	Pillow Ball Equipped/ Offset / Caster Adjustable	
		Q1075		2	Harden Rubber Equipped	
	REAR KNUCKLE BUSHING - UPPER/ LOWER	Q1273		2	Pillow Ball Equipped/ Connect To Upper/ Lower Arms	
	REAR KNUCKLE BUSHING - UPPER FRONT/ FRONT/ LOWER FRONT	Q1274		2	Pillow Ball Equipped/ Connect To Upper Front/ Toe / Trailing Arms	
		Q1272		2	Harden Rubber Equipped/ Connect To Upper Front/ Toe/ Trailing Arms	
STABILIZER LINK	REAR SUBFRAME ANTI - VIBRATION INSERT	Q0855		4	For '17-20 Pre-facelift Models	
		ADJ. STABILIZER LINK	8793-260	Adjustable	2	Range: 243-282 mm/ Ball stud: M12
			8659-140	Adjustable	2	Range: 125-164 mm/ Ball stud: M10
	8793-300		Adjustable	2	Range: 283-322 mm/ Ball stud: M12	
SWAY BAR	FRONT SWAY BAR	Q0614		5	32 mm	
	REAR SWAY BAR	Q0615		7	22 mm	

TESLA MODEL 3

ARM

Front upper camber kit allows fine adjustments to the front end camber setting of the vehicle. It can either help maximize wheel contact patch to improve cornering grip or get your car back to original alignment specs after lowering. The arms are made of high-strength CNC aluminum with anodized surface to offer high durability, strength and yet remain light-weight. With high quality pillow ball joints equipped, they also provide greater handling response over the factory components.

Q0869

FRONT UPPER CAMBER KIT
Pillow Ball Equipped



Q0603

FRONT UPPER CAMBER KIT
Harden Rubber Equipped

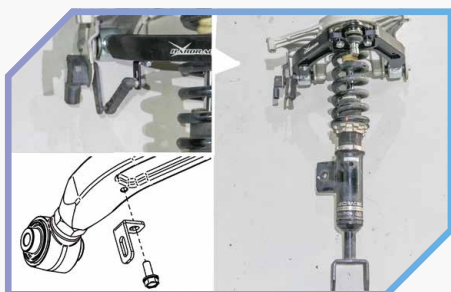

Q1319

FRONT LOWER FRONT ARM
Pillow Ball Equipped



Q1229

FRONT LOWER FRONT ARM
Harden Rubber Equipped



Q1320

FRONT LOWER REAR ARM
Pillow Ball Equipped



Q1230

FRONT LOWER REAR ARM
Harden Rubber Equipped



The control arms feature OE design with improved construction and materials. They are made of high quality forged aluminum alloy to ensure great strength and durability. The high quality pillow ball bearings and ball joints equipped also provide greater handling response over the factory components.

Q0997

REAR TOE KIT
Pillow Ball Equipped



Q0605

REAR TOE KIT
Harden Rubber Equipped



Q0996

REAR CAMBER KIT
Pillow Ball Equipped



Q0604

REAR CAMBER KIT
Harden Rubber Equipped



- Offers toe adjustability to suit various driving conditions.
- High-strength steel alloy construction.
- Premium quality pillow ball joints equipped/harden rubber equipped.
- Improve handling performance.
- OE direct fitment.



TESLA MODEL 3

The adjustable arms allow fine adjustments to the rear end alignment setting of the vehicle. It can either help achieve desired handling characteristic or get your car back to original alignment specs after lowering. The arms are made of high-strength steel alloys to offer high durability and strength. With premium quality pillow ball bushings equipped, they also provide more precise and solid handling response over the factory components.

Q0998

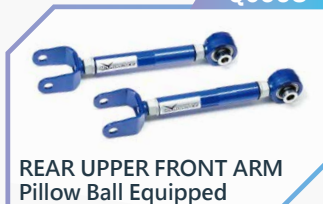

Q0612

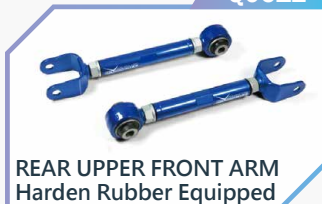

Q0999

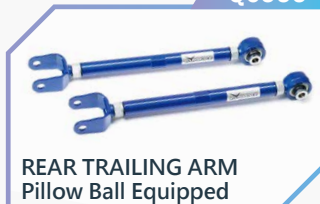

Q0613

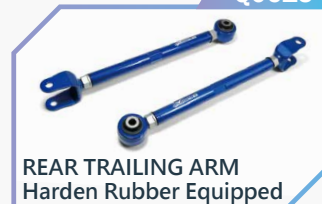

BAR AND BRACE

Braces stiffen up the chassis and minimize flex under acceleration, braking and cornering, providing more predictable handling and greater driving confidence. Made of high-strength CNC aluminum with anodized surface, It offers highest strength and yet remain light-weight.

Q0911

FRONT LOWER BRACE



Q0910

BRAKE MASTER CYLINDER STOPPER



Q0709

BRAKE MASTER CYLINDER STOPPER



TESLA MODEL 3

BUSHING

- The harden rubber bushings are made of high strength and anti-crack rubber materials to offer solid handling response and resistance to unwanted suspension movement during hard acceleration, braking and cornering.
- Pillow ball bushing provides excellent driver feedback, precise control and solid suspension feel. The bushing is made of precisely made high molecule plastic tube and specific steel alloy for superior durability and reliability. The Outer side utilizes TPV material anti-dust boot, 100% resistant from dust, water and oil, extend the life of the bushing.

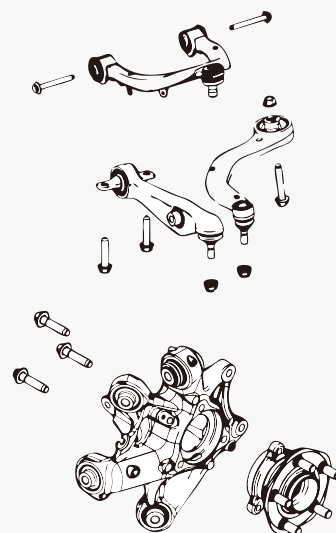

Subframe anti-vibration insert is a great choice to improve traction and get a more connected suspension feedback. The insert features CNC aluminum construction for precise fitment to the factory subframe bushings. By filling the void in the bushings, the inserts capably limit unwanted movement and firming up the subframe, eliminating wheel hop, power loss and sloppy suspension feel under harsh driving conditions.

Q0855

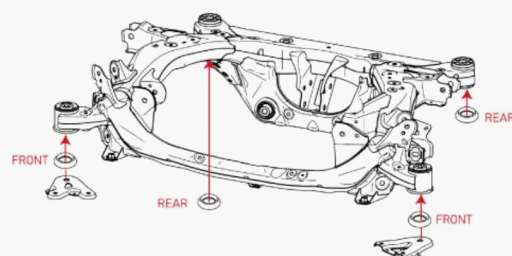
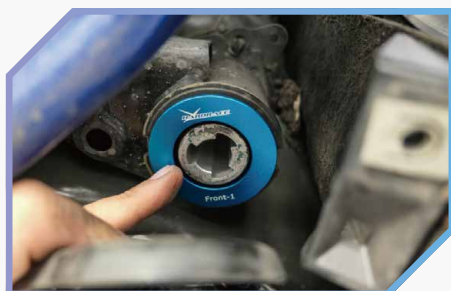

TESLA MODEL 3

STABILIZER LINK

The essential for getting connected! HARDRACE adjustable stabilizer links allow you to fine tune the position your sway bar for optimum handling. The adj. stabilizer link manufactured from high tensile steel with tight ball joints and rubber boots for superior strength and rigidity to extend its life.

- An absolute must for any lowered vehicle.
- Adjustable sway bar end links.
- Self-lubricating plastic bearing and bracket.
- Improves handling performance.
- Perfect for lowered vehicles.

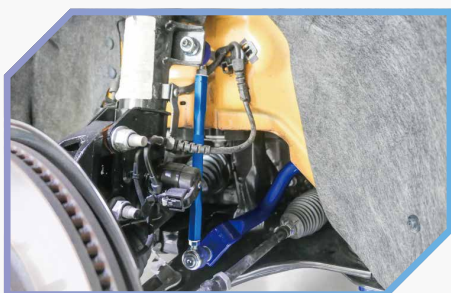

8793-260

Range:
243-282 mm



8659-140

Range:
125-164 mm



8793-300

Range:
283-322 mm



SWAY BAR

Sway Bar affects the handling and the car's over steer and under steer. It ties the lower suspension links together across the front or back, will keep your car flat in turns instead of leaning over to one side. Hardrace sway bars provide better control especially at high speeds cornering.

- Designed for OE direct replacement.
- Hollow internal structure.
- Heat treated.
- Correction of under or oversteer.
- Improve more grip and better handling.
- Increased stability while during high speed cornering.



Q0614 FRONT SWAY BAR 32 mm

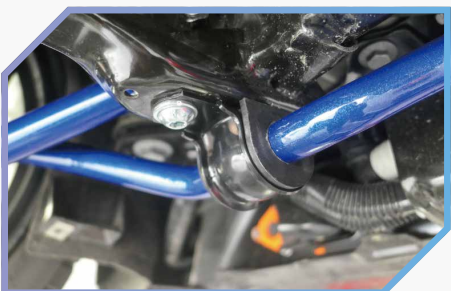

Q0615 REAR SWAY BAR 22 mm



TESLA MODEL 3

CHASSIS PARTS DIAGRAM

FRONT

Q0614 //
FRONT SWAY BAR

Q0603 //
FRONT UPPER CAMBER KIT

Q1320 //
FRONT LOWER REAR ARM

Q1229 //
FRONT LOWER FRONT ARM

Q0709 //
BRAKE MASTER CYLINDER STOPPER

Q0911 //
FRONT LOWER BRACE

REAR

Q0615 //
REAR SWAY BAR

Q0996 //
REAR CAMBER KIT

8793-300 //
ADJ. STABILIZER LINK

Q0855 //
REAR SUBFRAME ANTI - VIBRATION INSERT

Q0605 //
REAR TOE KIT

Q0999 //
REAR TRAILING ARM

