

Installation Instructions

安裝說明書

FRONT STRUT BRACE

引擎室拉桿

#Q0114

Application 適用車型

Suzuki Swift '17-present (ZC33)

Components 內含配件

① Strut brace 引擎室拉桿	1PCS
Bolt 螺絲 (M10x1.5x75)	2PCS
Nut 螺帽 (M10x1.5-17x10)	2PCS
Washer 華司 (20.8x10.7x2)	4PCS
② Bolt 螺絲 (M8x1.25x25)	2PCS
③ Bolt 螺絲 (M6x1.0x25)	2PCS
④ Bolt 螺絲 (M6x1.0x16-1)	2PCS
⑤ Nut 螺帽 (M8x1.25-12x6.5)	2PCS
⑥ Nut 螺帽 (M6x1.0-10x6)	2PCS
⑦ Washer 華司 (16x8.4x1.4)	10PCS

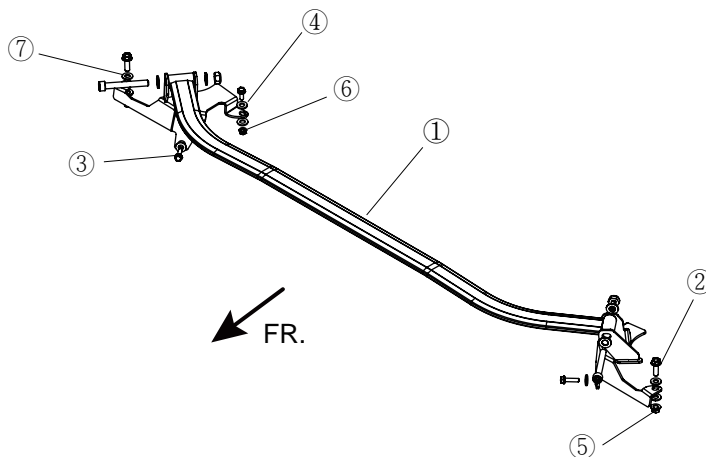

Caution 注意事項

- Installation is recommended to be performed by licensed mechanics with necessary tools to ensure proper installation and safety, or damage to the product or vehicle may occur.
- Note the routing and position of wires and cables before installation. Please refer to factory manual.
- Tighten bolts and nuts firmly using handtools, or with specified torque if mentioned.
- 安裝需由合格的專業技師及工具執行以確保安裝正確及安全，否則可能對產品或車輛造成傷害。
- 安裝前請記下線路安裝路徑及位置，或請參考原廠手冊。
- 請使用手動工具確實鎖緊螺帽及螺絲，或依照說明中標註的扭力上鎖。

Instructions 安裝說明

1. Attach ① Strut brace onto the both strut towers.
首先將 ①引擎室拉桿 置於兩側避震塔上。

2. Install supplied bolts, nuts and washers to the brace as shown in components figure, figure 1 and 2.
請依照配件圖、圖表一和圖表二指示，使用配件中的螺絲、螺帽以及華司，將引擎室拉桿固定於避震塔。

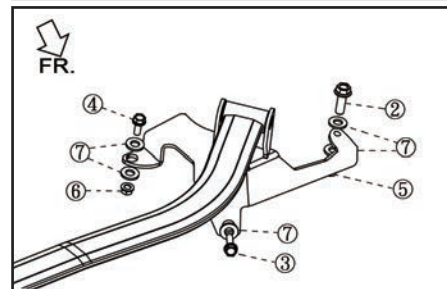
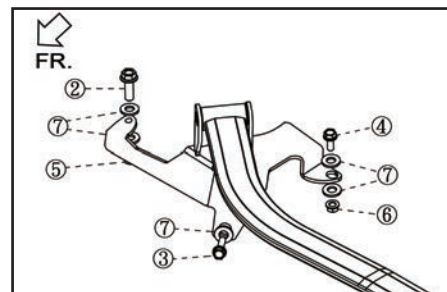

Illustration of installed state
完成示意圖