

Installation Instructions

安裝說明書

FRONT STRUT BRACE

引擎室拉桿

#8906

Application 適用車型

Honda HR-V/ Vezel '14-present

LHD models only 限用於左駕車型

Components 內含配件

① Strut brace 引擎室拉桿	1PCS
Bolt 螺絲 (M10x1.5x80)	2PCS
Nut 螺帽 (M10x1.5-17x10)	2PCS
Washer 華司 (20.8x10.7x2)	4PCS
② Button head allen bolt 圓頭內六角螺絲 (M10x1.5x30)	2PCS
③ Button head allen bolt 圓頭內六角螺絲 (M6x1.0x20)	5PCS
④ Flange nut 凸緣螺帽 (M10x1.5-17x10)	2PCS
⑤ Flange nut 凸緣螺帽 (M8x1.25-12x6.5)	2PCS
⑥ Flange nut 凸緣螺帽 (M6x1.0-10x6)	3PCS
⑦ Washer 華司 (32x13.5x3)	2PCS
⑧ Washer 華司 (18.8x6.4x1.5)	8PCS

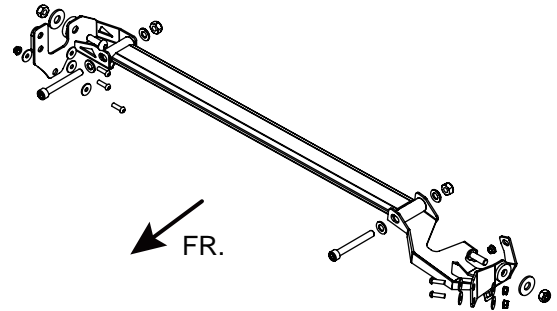

Caution 注意事項

- Installation is recommended to be performed by licensed mechanics with necessary tools to ensure proper installation and safety, or damage to the product or vehicle may occur.
- Note the routing and position of wires and cables before installation. Please refer to factory manual.
- Tighten bolts and nuts firmly using handtools, or with specified torque if mentioned.
- 安裝需由合格的專業技師及工具執行以確保安裝正確及安全，否則可能對產品或車輛造成傷害。
- 安裝前請記下線路安裝路徑及位置，或請參考原廠手冊。
- 請使用手動工具確實鎖緊螺帽及螺絲，或依照說明中標註的扭力上鎖。

Instructions 安裝說明

1. Open the hood, jack up front end of the vehicle and remove front wheels to access the strut towers from both engine bay and inside of wheel arches on both sides.

打開引擎蓋，將車輛前端升起後拆下前輪，以便同時從引擎室及輪拱內安裝拉桿。

2. Place ① Strut brace on the strut towers. Please note that the two holes on left bracket of the brace should be fitted to the brake master cylinder studs.

將 ① 引擎室拉桿 置於避震塔，請注意桿身右側的支架其中兩個鎖孔需對準剎車總泵的螺柱置入。

3. Once the brace is in place, install supplied bolts, nuts and washers to brake master cylinder and strut towers on both sides from engine bay and inside of wheel arches to secure the brace.

拉桿固定完成後，請依照圖表一和圖表二指示，使用配件中的螺絲、螺帽以及華司，將引擎室拉桿固定於兩側避震塔及剎車總泵。

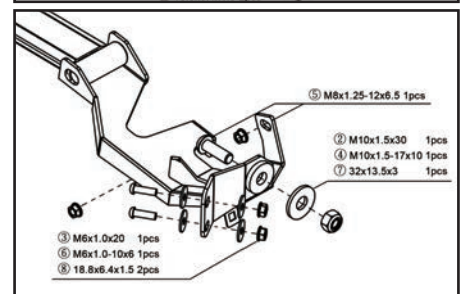
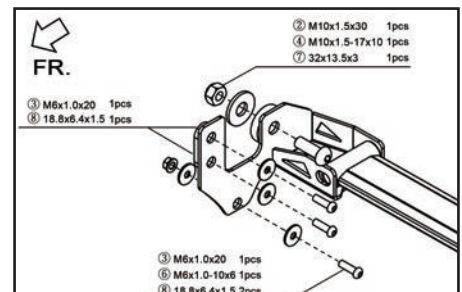

Illustration of installed state
完成示意圖