

Installation Instructions

安裝說明書

FRONT COMPLIANCE OFFSET BUSHING

前下三角架偏心鐵套

#Q0261

Application 適用車型

Honda Civic '92-96
Honda Del Sol '92-98
Acura Integra '94-01

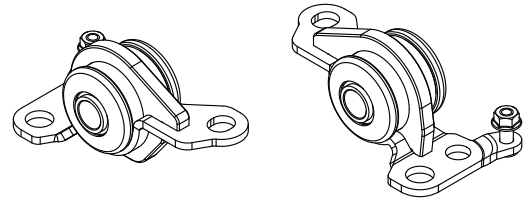

Components 內含配件

- ① Offset bushing-RH 偏心鐵套-右 1pcs
- ② Offset bushing-LH 偏心鐵套-左 1pcs

Caution 注意事項

- Installation is recommended to be performed by licensed mechanics with necessary tools to ensure proper installation and safety, or damage to the product or vehicle may occur.
- Note the routing and position of wires and cables before installation. Please refer to factory manual.
- Tighten bolts and nuts firmly using handtools, or with specified torque if mentioned.
- 安裝需由合格的專業技師及工具執行以確保安裝正確及安全，否則可能對產品或車輛造成傷害。
- 安裝前請記下線路安裝路徑及位置，或請參考原廠手冊。
- 請使用手動工具確實鎖緊螺帽及螺絲，或依照說明中標註的扭力上鎖。

Instructions 安裝說明

1. Remove front lower control arms from the vehicle on both sides to replace factory compliance bushing with the offset bushings.
卸下兩側前下控制臂，並將原廠控制臂鐵套更換為偏心鐵套。
2. Reinstall the control arms to the vehicle.
鐵套安裝完成後將前下控制臂裝回車輛。
3. Install the forks to shock absorbers using factory bolts.
使用拆下的原廠螺絲將避震叉安裝於前避震器。

Note 提示

※ The offset bushing sits 20mm outer than the factory ones. By moving the ball joints forward to increase 1~2 degrees of caster angles, straight line and high speed stability will be improved.

此偏心鐵套位置較原廠外移20mm，藉由將和尚頭位置前移能使後傾角增加1~2度，提升直線及高速行駛時的穩定性。

Please have the vehicle professionally aligned after installation.
請於安裝完成後接受電腦四輪定位校正

Illustration of installed state
安裝完成示意圖

