

Installation Instructions

安裝說明書

FRONT TENSION ROD

前扭力桿

#Q0208

Application 適用車型

Nissan Silvia/180SX/240SX (S13) '89-94
Nissan Skyline 2WD (R32) '89-94
Nissan Cefiro (A31) '88-94
Nissan Fairlady / 300ZX (Z32) '89-00

Components 內含配件

① Tension rod - RH 扭力桿-右	1pcs
② Tension rod - LH 扭力桿-左	1pcs
③ Bolt 螺絲(M12x1.25x32)	4pcs
④ Nut 螺帽(M12x1.25-19x13.5)	4pcs

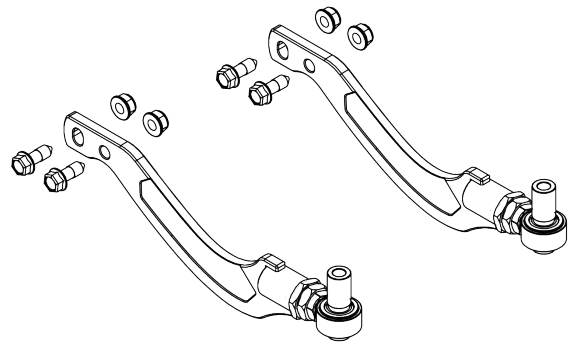

Caution 注意事項

- Installation is recommended to be performed by licensed mechanics with necessary tools to ensure proper installation and safety, or damage to the product or vehicle may occur.
- Note the routing and position of wires and cables before installation. Please refer to factory manual.
- Tighten bolts and nuts firmly using handtools, or with specified torque if mentioned.
- 安裝需由合格的專業技師及工具執行以確保安裝正確及安全，否則可能對產品或車輛造成傷害。
- 安裝前請記下線路安裝路徑及位置，或請參考原廠手冊。
- 請使用手動工具確實鎖緊螺帽及螺絲，或依照說明中標註的扭力上鎖。

Instructions 安裝說明

1. Remove the factory tension rods from subframe and lower control arms.
將原廠扭力桿從副車架及前下控制臂中卸下。
2. Adjust the nuts on Hardrace tension rods to desired caster settings, or adjust to stock length to keep factory setting
調整 Hardrace 扭力桿螺帽達到理想的後傾角設定，或調整至與原廠扭力桿等長以維持原廠配置。
3. Install tension rods to the subframe using factory bolts, and to the control arms using supplied M12 bolts and nuts. Please note the side with pillow ball sleeve longer should be installed toward outer side, and the curve designed for tires and wheels clearance should be installed toward the inner side of vehicle.
(See figure 2)
沿用原廠螺絲將扭力桿固定副車架，並使用配件 M12 螺絲及螺帽將扭力桿固定於前下控制臂。安裝時請注意魚眼鐵套較長的一端應面向車輛外側，而桿身彎曲應朝向車輛內側。(參考圖表二)
4. Please have the vehicle professionally aligned after installation.
請於安裝完成後接受電腦四輪定位校正。

Illustration of installed state
安裝完成示意圖

