

# Installation Instructions

## 安裝說明書

REAR ADD-ON SWAY BAR  
後加裝型防傾桿, 17mm  
#Q0593

### Application 適用車型

MAZDA 3 (BP) '19- FWD  
MAZDA CX-30 (DM) '19- FWD

### Components 內含配件

- |                               |      |
|-------------------------------|------|
| ① Sway bar 防傾桿桿身.....         | 1pcs |
| ② Lower bracket-RH 下支架-右..... | 1pcs |
| ③ Lower bracket-LH 下支架-左..... | 1pcs |
| ④ Upper bracket 上支架.....      | 2pcs |
| ⑤ Bolt 螺絲 (M10x1.25x25).....  | 8pcs |
| ⑥ Nut 螺帽 (M10x1.25-14x9)..... | 8pcs |
| ⑦ Washer 華司 (26x10.5x2).....  | 8pcs |
| ⑧ Bolt 螺絲 (M6x1.0x50).....    | 2pcs |
| ⑨ Spacer 墊高座 .....            | 2pcs |

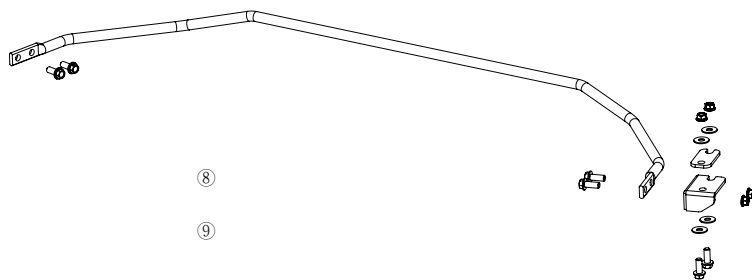
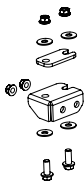

Accessories for OE plastic cover  
鎖護板配件

- |  |              |
|--|--------------|
|  | Bolt 螺絲X2    |
|  | Spacer 墊高座X2 |

### Caution 注意事項

- Installation is recommended to be performed by licensed mechanics with necessary tools to ensure safety. Incorrect installation may cause injury, damage to the product or vehicle. 安裝建議由合格的技師及工具執行以確保安全。安裝錯誤可能對人員、產品及車輛造成傷害。
- Note the routing of wires and cables before installation, or please refer to factory manual. 安裝前請事先記下線路的安裝路徑及位置以維持原廠配置。有疑問時請參考原廠手冊。
- Tighten bolts and nuts firmly by using handtools, and with specified torque if mentioned. 安裝過程請使用手動工具確實鎖緊螺帽及螺絲。如有特別註明請依照說明指示的扭力上鎖。

### Instructions 安裝說明

1. Remove the plastic rear axle cover from rear axle beam on one side.  
將後塑膠護板從後樑上卸下。



2. Install the brackets to shock absorber mountings using supplied M10x1.25x25 hardware.

(The upper bracket must place inside the rear axle)  
使用M10x1.25x25配件。將下支架由減震筒鎖點處由下安裝鎖上。  
(上支架需安裝在後樑內側)

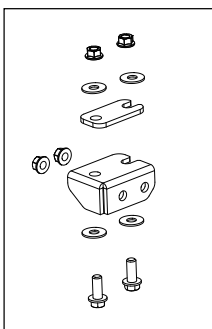

3. Install the sway bar to brackets using supplied M10 hardware.

使用M10x1.25配件。將防傾桿安裝至兩側支架。

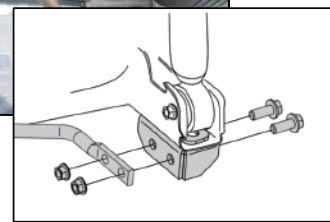
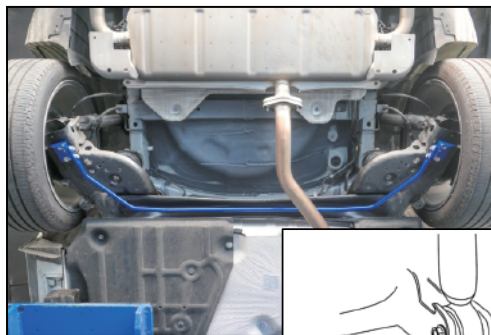

4. Install the spacer and reinstall the plastic rear axle cover using M6 bolt.

安裝增高座使用M6螺絲將後塑膠護板安裝回原處。



Illustration of installed state  
安裝完成示意圖