

Installation Instructions

安裝說明書

FRONT ADD-ON SWAY BAR

前加裝型防傾桿

#Q1176/Q1177

Components 內含配件

- ① Bracket 防傾桿支架.....1pcs
- ② Sway bar 防傾桿.....1pcs
- ③ Sway bar bushing 防傾桿橡皮.....2pcs
- ④ Bushing bracket - 橡皮固定環.....2pcs
- ⑤ End link 防傾桿連接桿/李仔串.....2pcs
- ⑥ Bolt-Flange 凸緣螺絲 (M10x1.25x20).....4pcs
- ⑦ Washer-Flat 平面華司 (28x15.2x2.5).....1pcs
- ⑧ Washer-Convex 凸面華司 (32.2x12.4x6.5)..2pcs

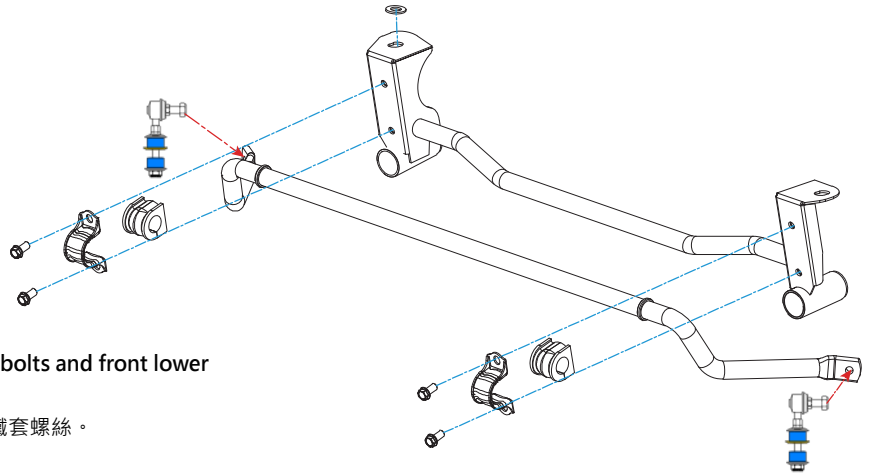

Instructions 安裝說明

1. Remove the factory subframe upper front mounting bolts and front lower control arm front bushing bolts.
拆下原車固定於副車架上前端螺絲以及前下控制臂前端鐵套螺絲。
2. Install ① bracket to front subframe.
將 ①防傾桿支架 安裝至前副車架。
3. Insert ⑦ Flat Washer between the subframe and bracket for the RH side subframe mounting hole. (See circled)
於右側副車架鎖孔(圈起處)·將 ⑦平面華司 置於防傾桿支架及副車架之間。
4. Reinstall the factory subframe and control arm bushing bolts to secure the bracket.
將原廠副車架及前下控制臂鐵套螺絲裝回鎖緊以固定防傾桿支架。

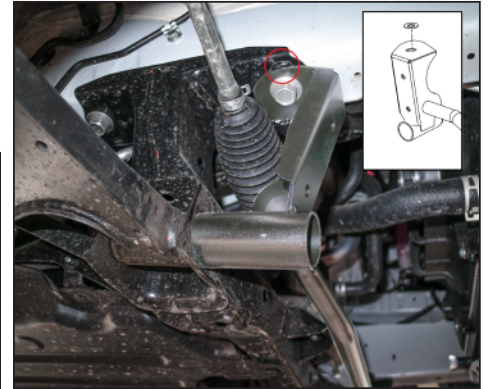
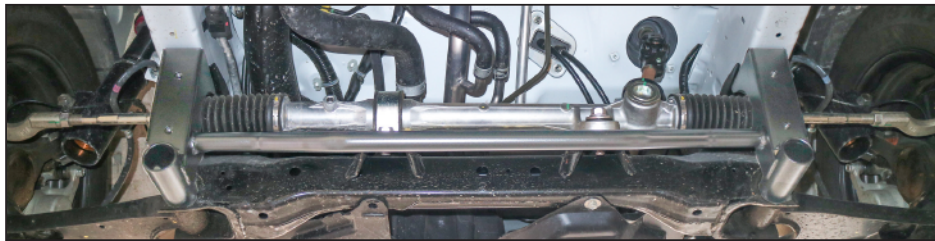

5. Install ② Sway bar to the bracket using supplied ③ Sway bar bushings, ④ Bushing brackets and ⑥ Flange bolts.
使用 ③防傾桿橡皮, ④橡皮固定環 及 ⑥凸緣螺絲·將 ②防傾桿 安裝至支架。
6. Install ⑧ Convex washers between the two bushings of ⑤ End links.
將 ⑧凸面華司 串入安裝至 ⑤李仔串 的兩塊橡皮之間。
7. Install ⑤ End links to connect the sway bar and front lower control arms.
安裝 ⑤李仔串·將防傾桿連接至前下控制臂。

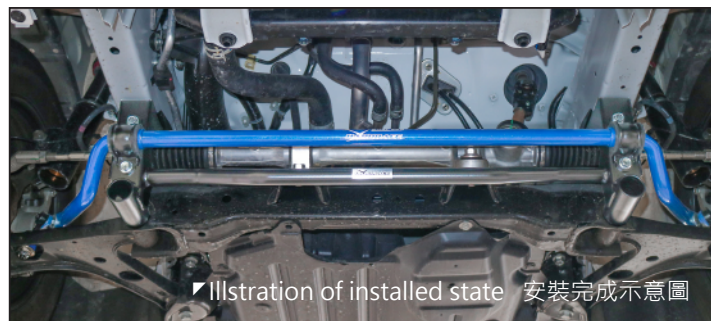
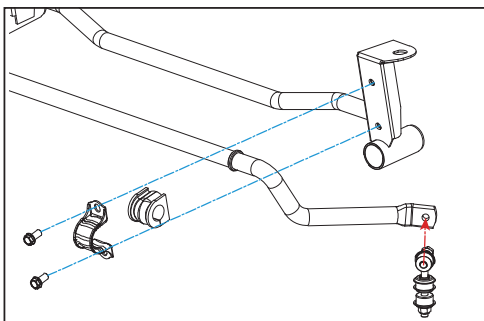
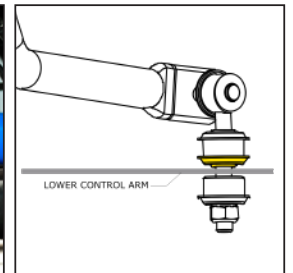

Illustration of installed state 安裝完成示意圖

Caution 注意事項

- Installation is recommended to be performed by licensed mechanics with necessary tools to ensure safety. Incorrect installation may cause injury, damage to the product or vehicle.
安裝建議由合格的技師及工具執行以確保安全·安裝錯誤可能對人員、產品及車輛造成傷害。
- Note the routing of wires and cables before installation, or please refer to factory manual.
安裝前請事先記下線路的安裝路徑及位置以維持原廠配置·有疑問時請參考原廠手冊。

- Tighten bolts and nuts firmly by using handtools, and with specified torque if mentioned.
安裝過程請使用手動工具確實鎖緊螺帽及螺絲·如有特別註明請依照說明指示的扭力上鎖。