

# Installation Instructions

## 安裝說明書

FRONT LOWER BRACE

前下拉桿

#Q1342

### Application 適用車型

Toyota Yaris Cross AC200 2023-Present (Asia-Spec)

### Components 內含配件

- ① Main bar (R+L) 主結構桿 (左+右) .....2pcs
- ② Front side bracket (R+L) 前端支架 (左+右) ....2pcs
- ③ Flange bolt 凸緣螺絲 (M10x1.25x25) .....2pcs
- ④ Flange bolt 凸緣螺絲 (M6x1.0x25) .....6pcs
- ⑤ Washer 華司 (6mm) .....6pcs

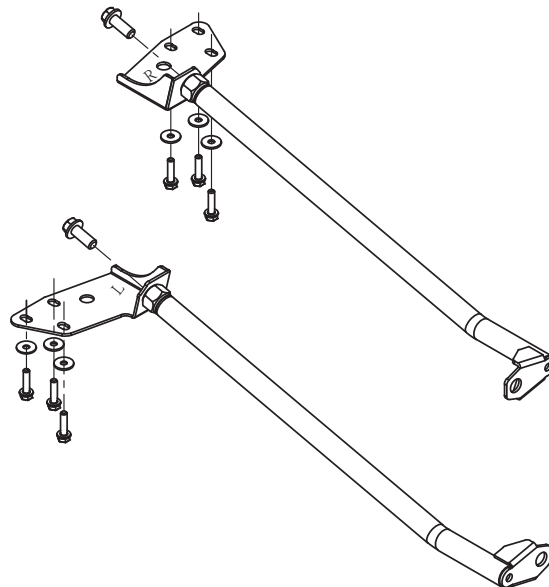

### Caution 注意事項

- Installation is recommended to be performed by licensed mechanics with necessary tools to ensure safety. Incorrect installation may cause injury, damage to the product or vehicle.  
安裝建議由合格的技師及工具執行以確保安全。安裝錯誤可能對人員、產品及車輛造成傷害。
- Note the routing of wires and cables before installation, or please refer to factory manual.  
安裝前請事先記下線路的安裝路徑及位置以維持原廠配置。有疑問時請參考原廠手冊。
- Tighten bolts and nuts firmly by using handtools, and with specified torque if mentioned.  
安裝過程請使用手動工具確實鎖緊螺帽及螺絲。如有特別註明請依照說明指示的扭力上鎖。

### Instructions 安裝說明

#### 1. Front side brackets installation

Remove the factory radiator support lower mounting bolts and insert ② brackets to the space between the panels.

Then install ④ bolts and ⑤ washers to secure the brackets.

前端支架安裝

拆卸原廠水箱架下端固定螺絲，並將 ② 前端支架插入鉸件縫隙。  
完成後使用 ④ 螺絲及 ⑤ 華司鎖緊固定。



#### 2. Main arm installation

Remove the lower control arm front side mounting bolts.

Then install ② main bar to the front side brackets using ③ bolts and to the control arms reusing factory bolts.

主桿身安裝

拆卸下三角架/控制臂的前端固定螺絲，並使用 ③ 螺絲，將 ② 主桿身安裝至前端支架，另一端使用原廠螺絲鎖至三角架/控制臂鎖點。



► Illustration of installed state 安裝完成示意圖